

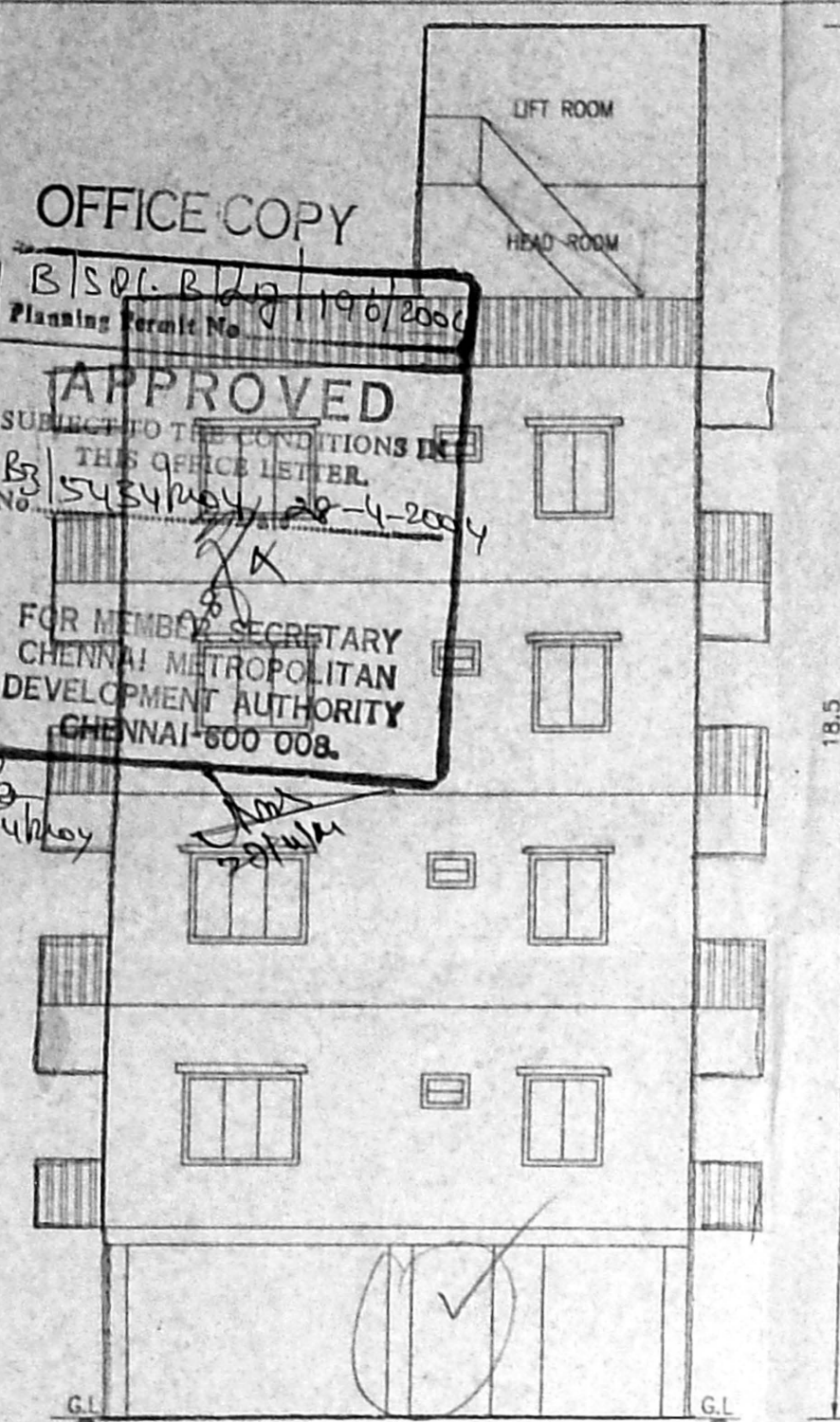

OFFICE COPY
 B.S.P. No. 17069
 Planning Permit No. 17069/2004
APPROVED
 SUBMITTED TO THE CONDITIONS IN THIS OBJECT LETTER.
 No. 5549/2004-4-2004
 FOR MEMBER SECRETARY
 CHENNAI METROPOLITAN
 DEVELOPMENT AUTHORITY
 CHENNAI-600 008.

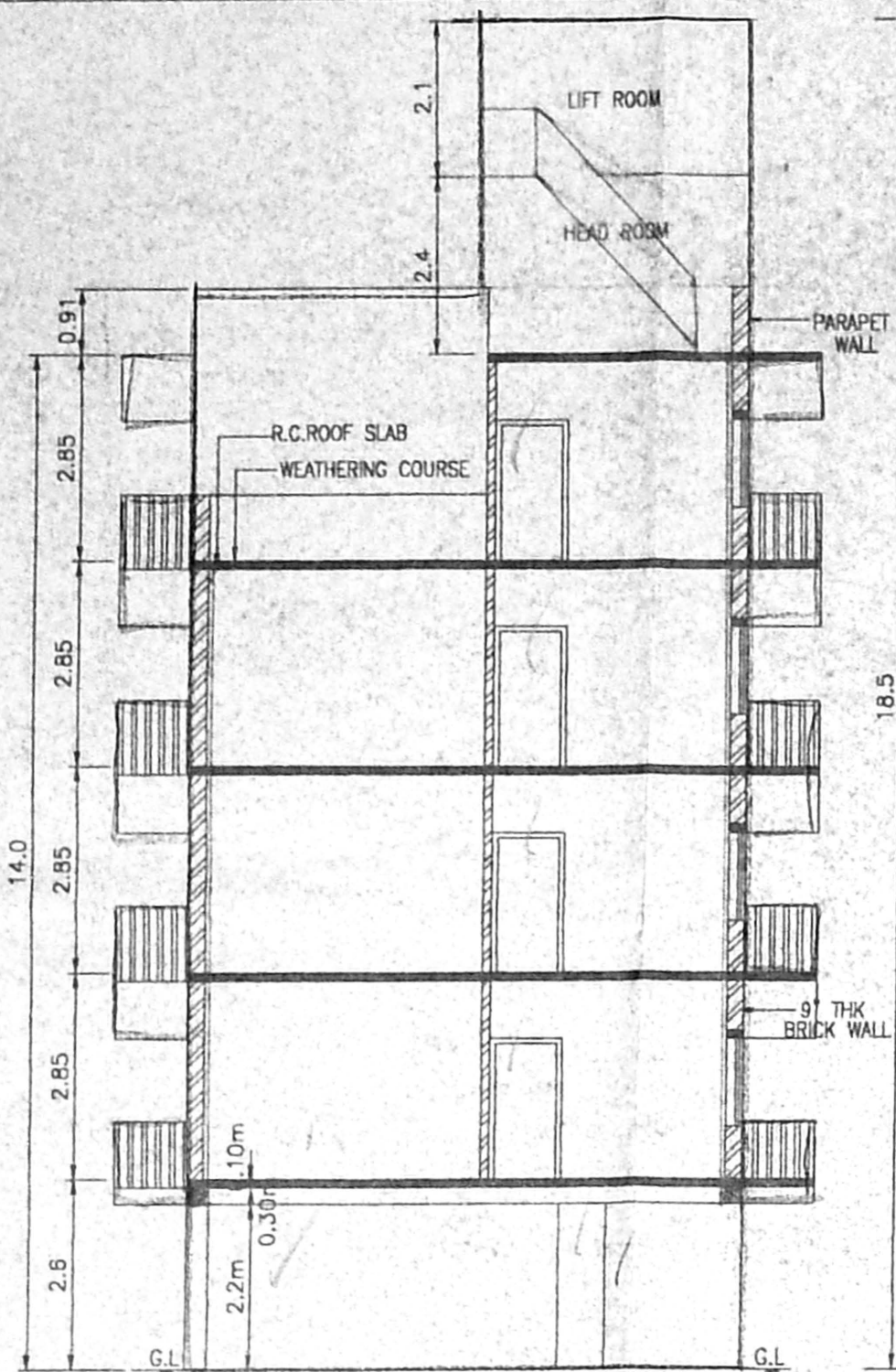

ELEVATION
 56'-0" (17069)



SECTION ON 'A-A'

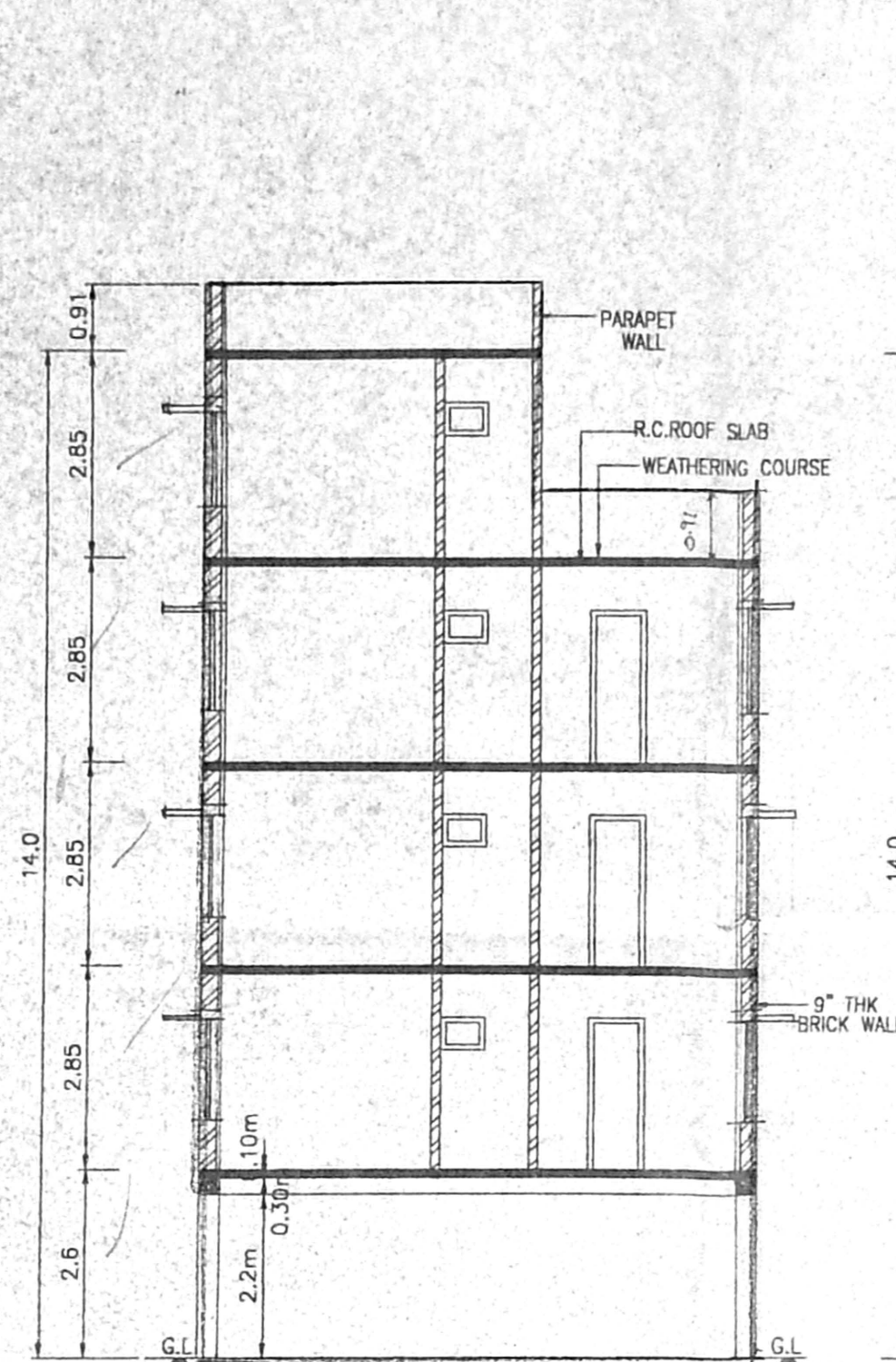

SECTION ON 'B-B'

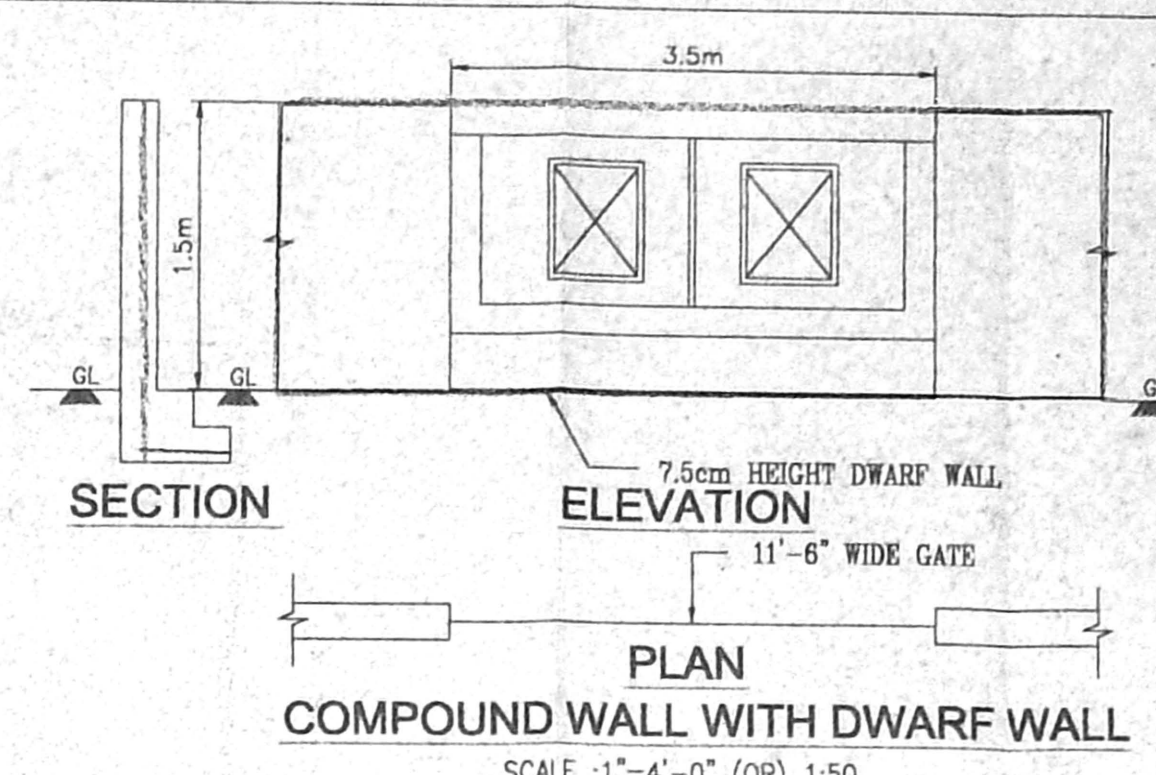

PLAN
 COMPOUND WALL WITH DWARF WALL
 SCALE: 1"=4'-0" (OR) 1:50

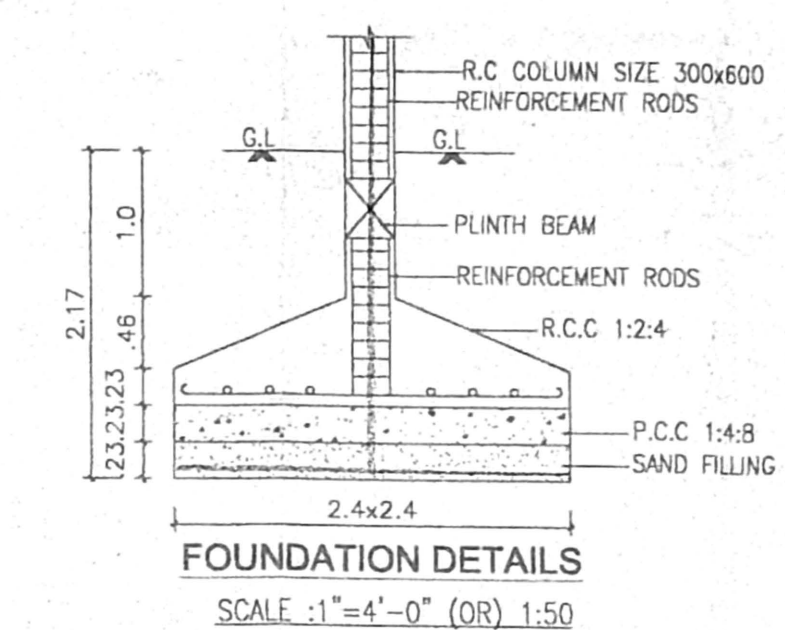

FOUNDATION DETAILS
 SCALE: 1"=4'-0" (OR) 1:50

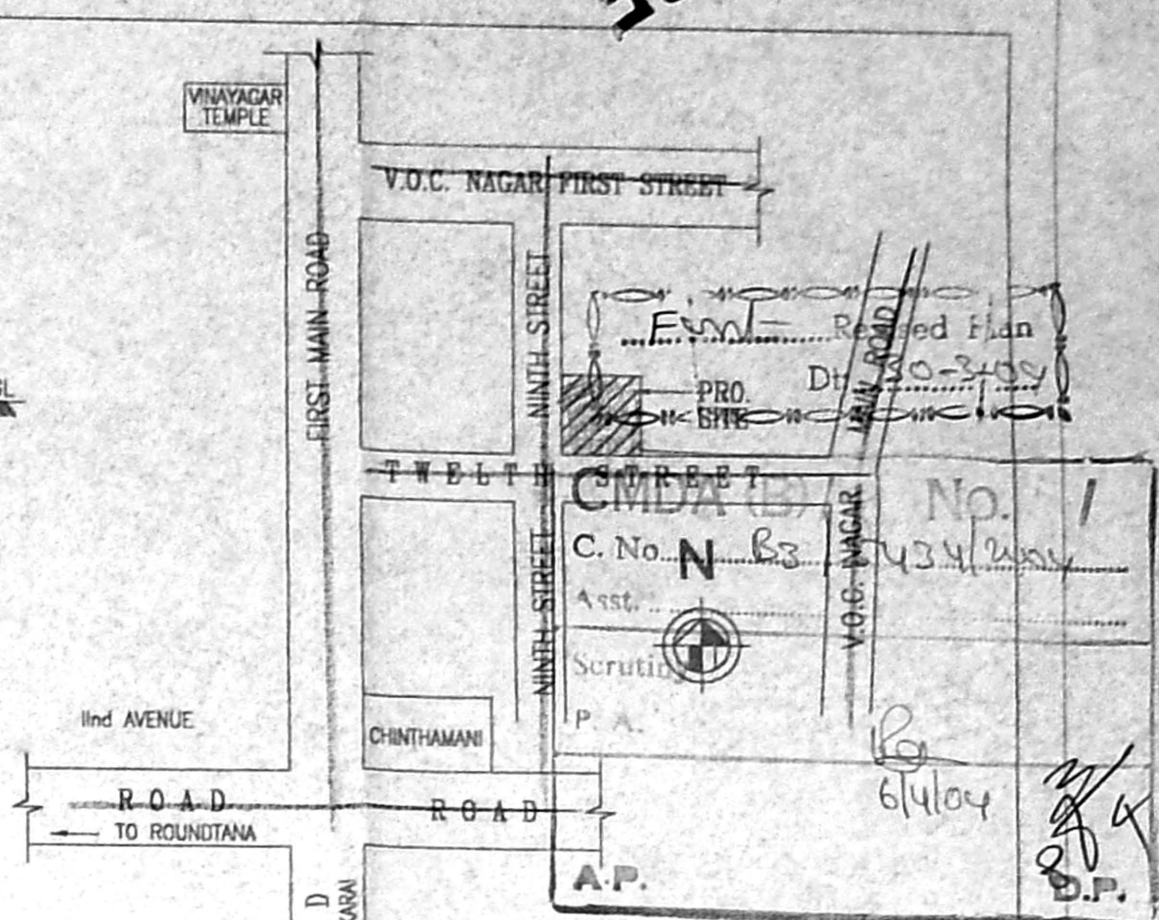

KEY PLAN
 SCALE: N.T.S.

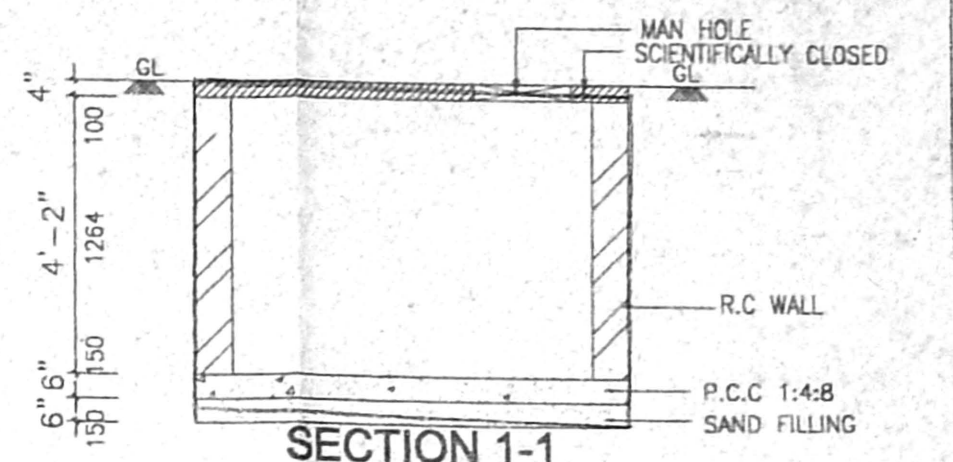

SECTION 1-1

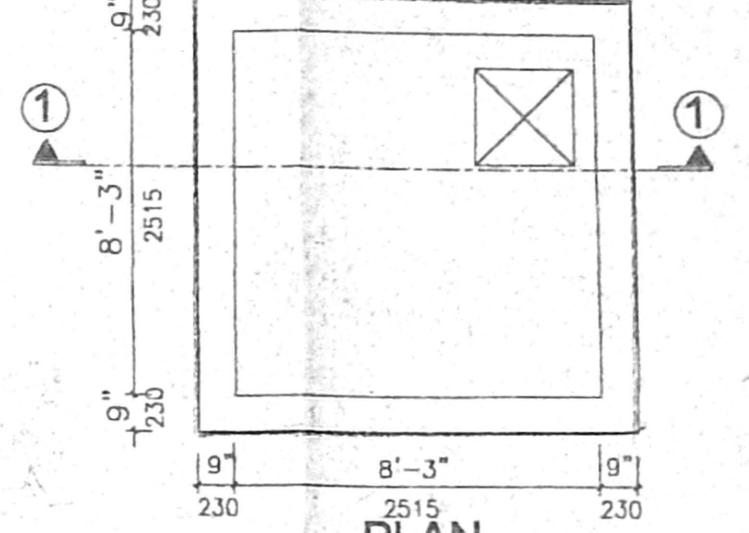

SUMP SCIENTIFICALLY CLOSED

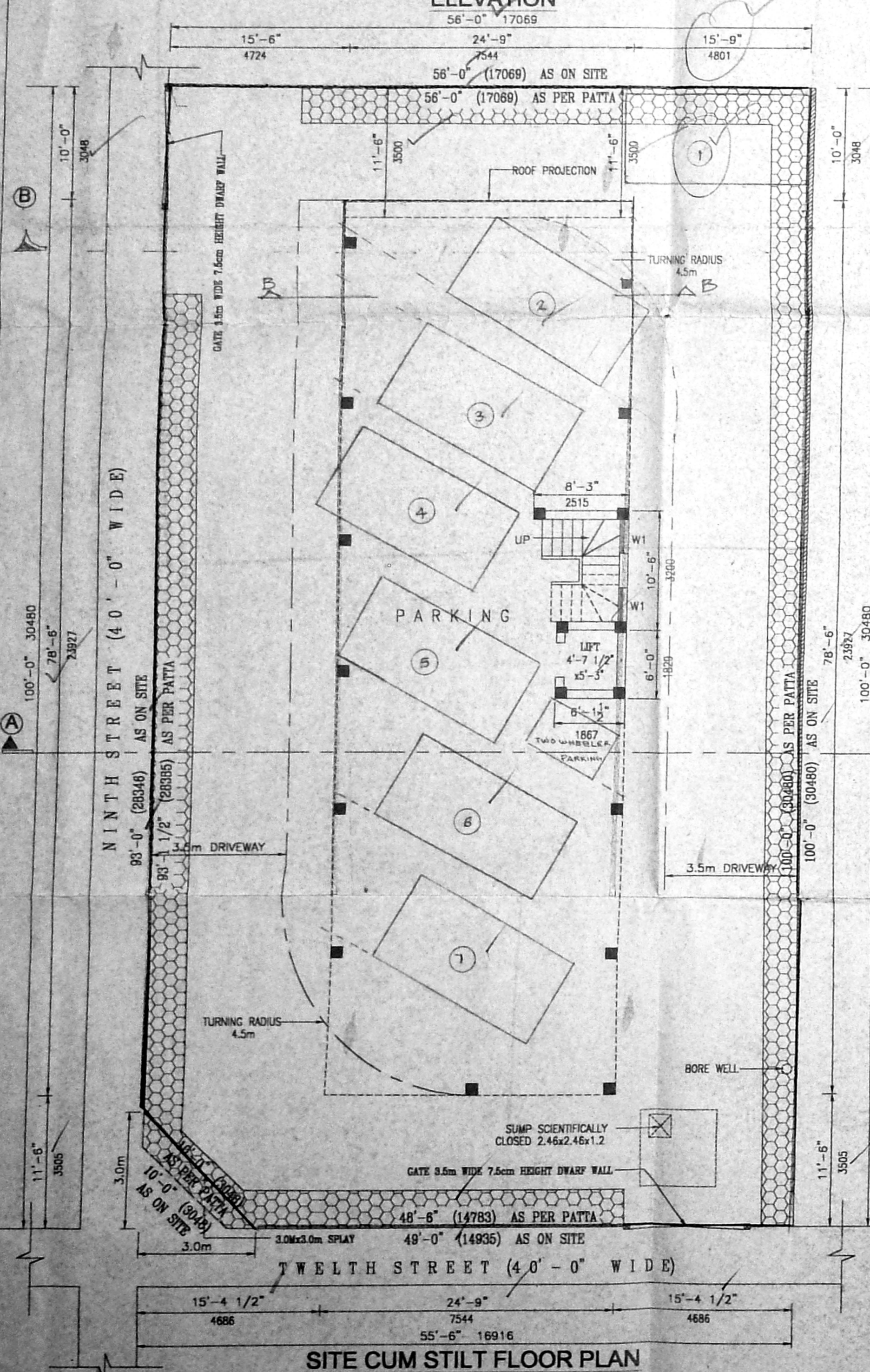

SITE CUM STILT FLOOR PLAN

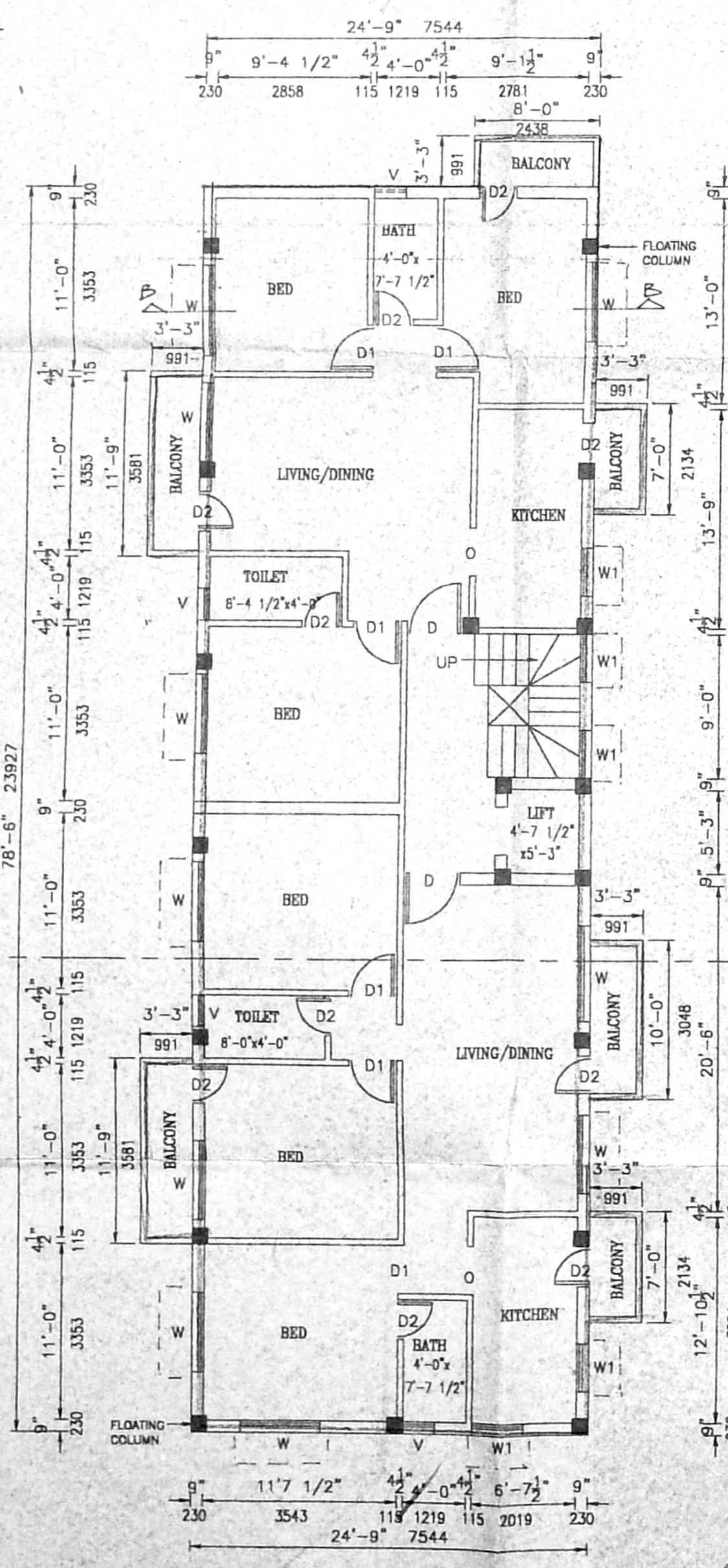

TYPICAL FLOOR PLAN (I, II & III FLOOR)

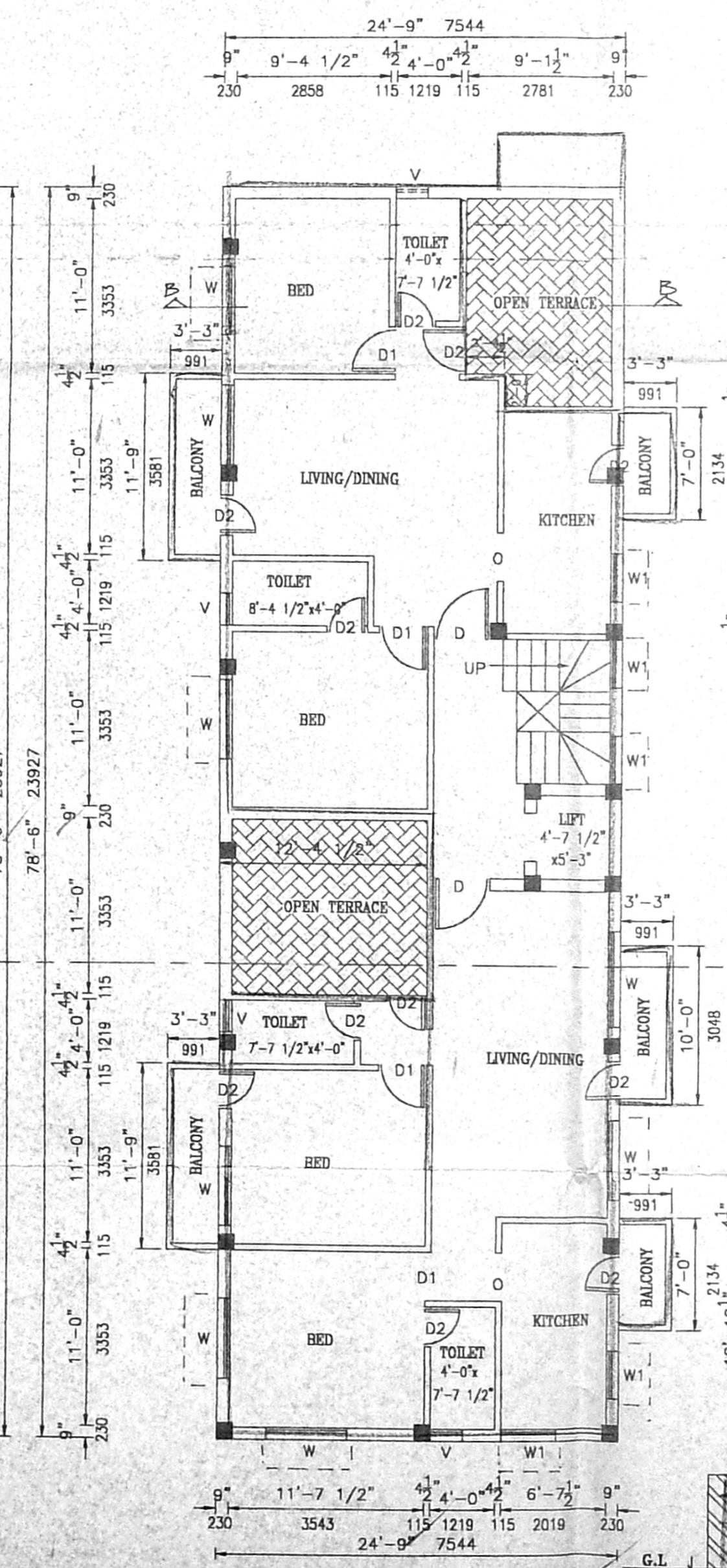

FOURTH FLOOR PLAN

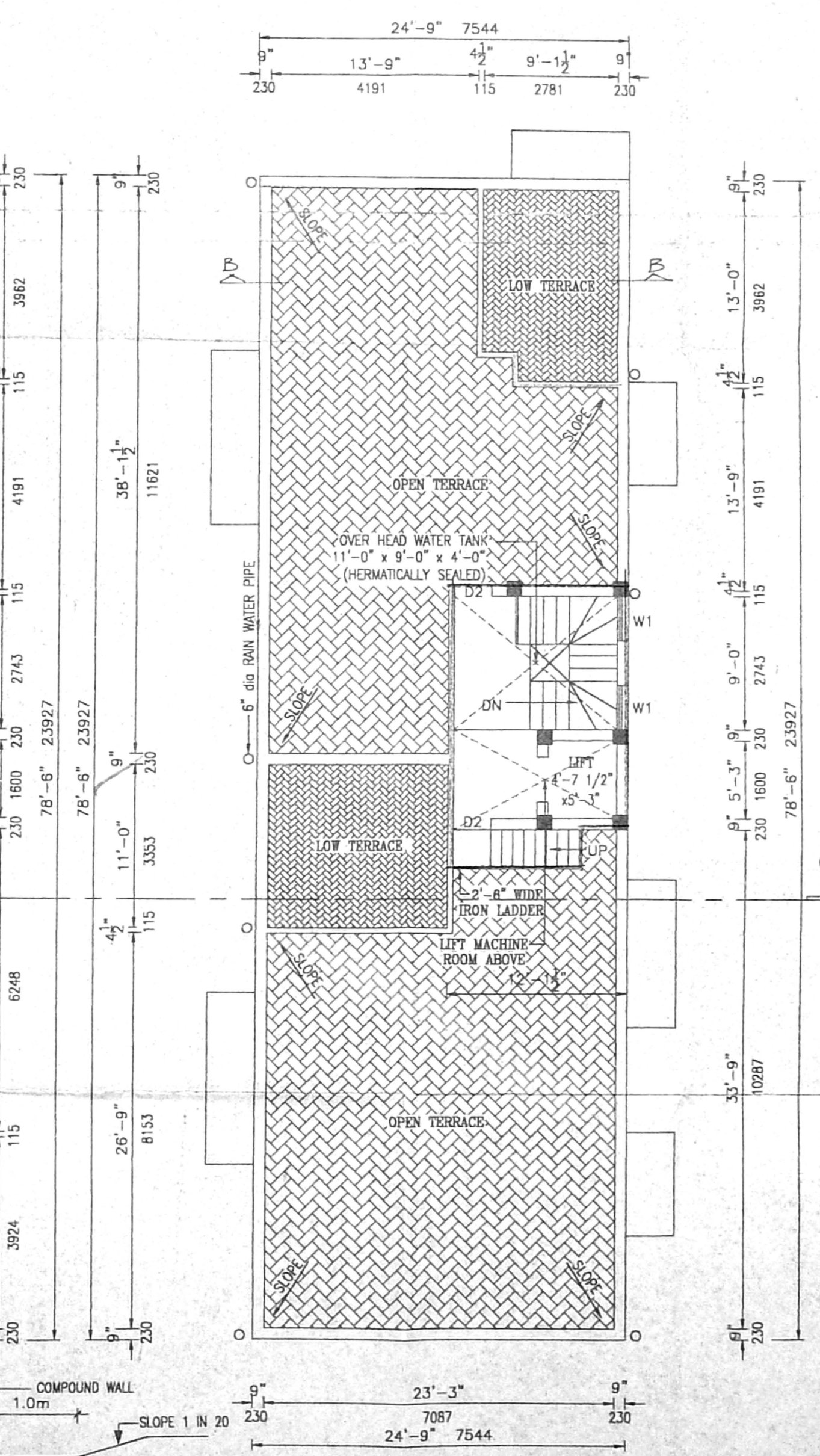

TERRACE FLOOR PLAN

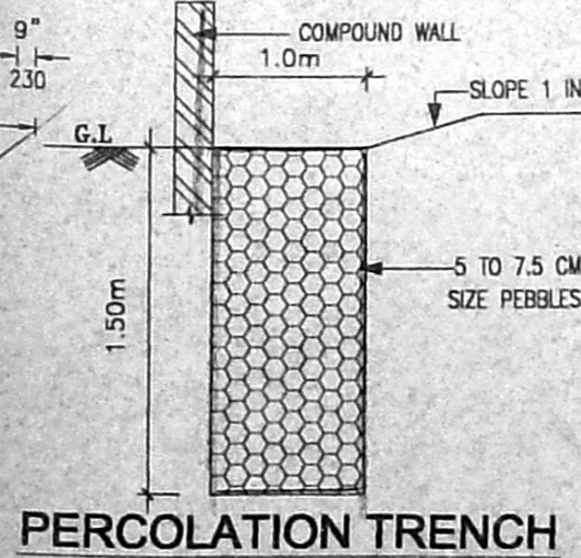

PERCOLATION TRENCH

PLAN SHOWING THE PROPOSED RESIDENTIAL BUILDING IN T.S.NO.17, BLOCK NO.5, S.NO.47 pt, 2/4.5 & 6 pt (AS PER PATTA), [2/5 pt AS PER DOCUMENT] OF PERIAR KUDAL VILLAGE AT PLOT NO. G-53, TWELTH STREET, ANNA NAGAR EAST, CHENNAI, CORPORATION OF CHENNAI, ZONE-V, DIVISION-67.

SPECIFICATION

FOUNDATION SHALL BE OF R.C.C. COLUMNS, R.C.C. WORK IN M25 CONC. WALLS SHALL BE OF B.W. IN C.M. 1:5 ROOFING SHALL BE OF RCC ROOFING. WEATHERING COURSE TWO COURSE OF BITUMEN WITH FLAT TILES ABOVE

SCHEDULE OF JOINERY

D	MAIN DOOR	3'-3" X 7'-0"
D1	DOOR	3'-0" X 7'-0"
D2	-DO-	2'-9" X 7'-0"
W	WINDOW	4'-6" X 4'-6"
W1	-DO-	3'-0" X 4'-6"
V	VENTILATOR	2'-0" X 2'-0"

COLOR INDEX

PROPOSED ROAD BOUNDARY

AREA STATEMENT

	Sq.Ft	Sq.M
PLOT EXTENT AS PER DOCUMENT	5576.00	518.02
PLOT EXTENT AS PER PATTA	5565.00	517.00
STILT FLOOR AREA	124.00	11.52
FIRST FLOOR AREA	2123.00	197.23
SECOND FLOOR AREA	2123.00	197.23
THIRD FLOOR AREA	2123.00	197.23
FOURTH FLOOR AREA	1824.00	169.45
TOTAL	8317.00	772.66
F. S. I.	1.49	
PLOT COVERAGE	38.14%	

SCALE: 1"=8'-0"

OWNER/GPA *[Signature]*

S. ATHIVANAN, B.E.,
 Class - I, Licensed Surveyor - No. 192
 Corporation of Chennai
 5, Nathamuni Street, 1st Floor,
 Chennai - 17, Phone: 26134624
 Mobile: 31038440

LICENSED SURVEYOR